

# MODEL RSR-7H

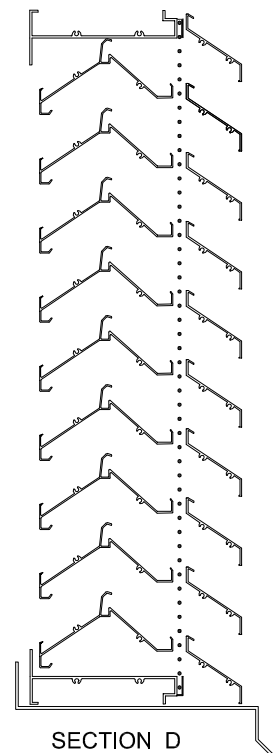

SECTION E  
CONCEALED  
MULLION

SECTION D

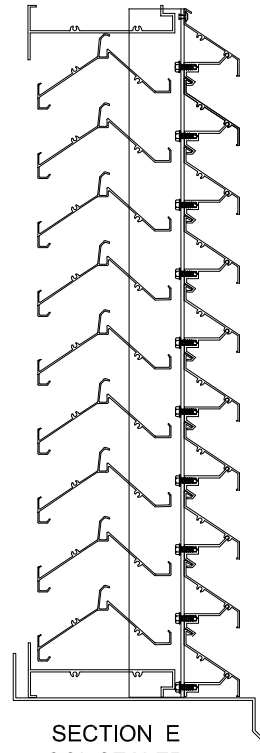
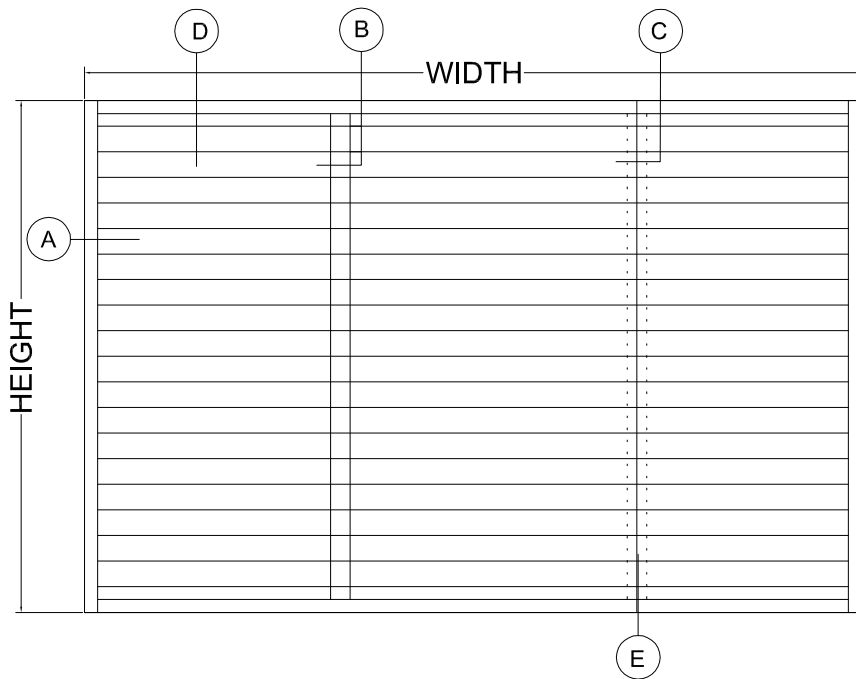
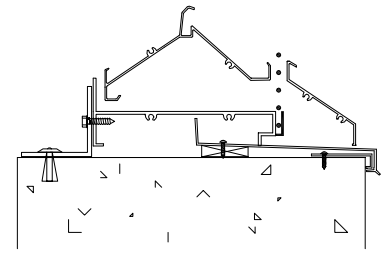
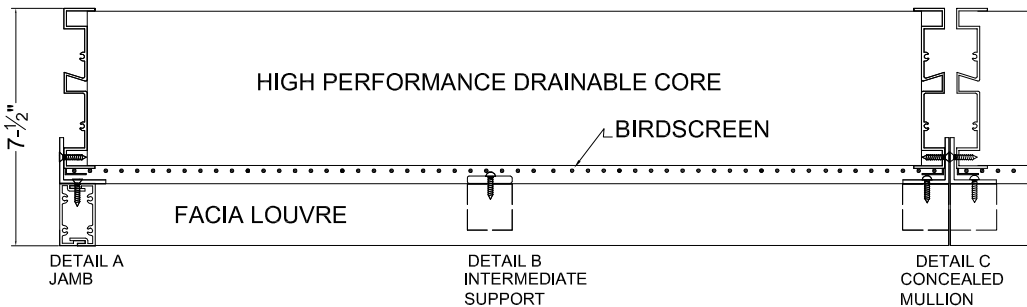

STANDARD SILL OPTION

## RSR-7H SPECIFICATIONS

BLADES HIGH PERFORMANCE DRAINABLE RAIN STORM RESISTANT CORE LOUVRE  
CONTINUOUS BLADE FACIA LOUVRE

FRAME CHANNEL TYPE C DRAINABLE JAMB

EXTRUDED ALUMINUM 6063-T52

DRAINABLE  
FRAME .081 (2mm)   
BLADE .060 (1.5mm)

FACIA  
FRAME .081 (2mm)   
BLADE .060 (1.5mm)

MULLIONS - AT DRAINABLE LOUVRE TYPE IM  
CONCEALED MULLION AT FACIA LOUVRE TYPE CM

SCREENS - ALUM. TYPE A  
1/2" X 1/2" .063 WIRE  
C/W FRAME

- GALVANIZED TYPE G  
1/2" X 1/2" 19 GAUGE

- INSECT TYPE I  
18X14 ALUMINUM MESH

ASSEMBY - S/S MECHANICAL STANDARD

L#	QUANT.	OPENING SIZE		FRAME	MULL.	SECTIONS WIDE	SCREENS	LOCATION / NOTES
		WIDTH	HEIGHT					
L-1								
L-2								
L-3								
L-4								
L-5								
L-6								
L-7								

## McGILL LOUVRES

1734 Orangebrook Crt. (905) 420-0485 TEL.  
Pickering Ontario (905) 420-4564 FAX  
CANADA (888)-624-0485 TEL.  
L1W 3G8 (888)-624-4554 FAX  
rev. 6/04 EMAIL : engineering@the-mcgill-group.com

## FINISHES

COLOUR # \_\_\_\_\_

- MILL FINISH
- 5000 SERIES AAMA -603 BAKED ENAMEL
- 10000 SERIES AAMA -605.2 KYNAR 2 COAT
- 15000 SERIES AAMA -605.2 KYNAR 3 COAT
- CLEAR ANODIZING  .0004  .0007
- COLOUR ANODIZING \_\_\_\_\_

PROJECT

ARCH/ENG.

CONTRACTOR

REPRESENTATIVE

SCALE DATE

SHEET

NTS

OF