

Project: \_\_\_\_\_ Sheet: \_\_\_\_\_  
 Architect: \_\_\_\_\_ of \_\_\_\_\_  
 Customer: \_\_\_\_\_ Date: \_\_\_\_\_  
 Rep.: \_\_\_\_\_

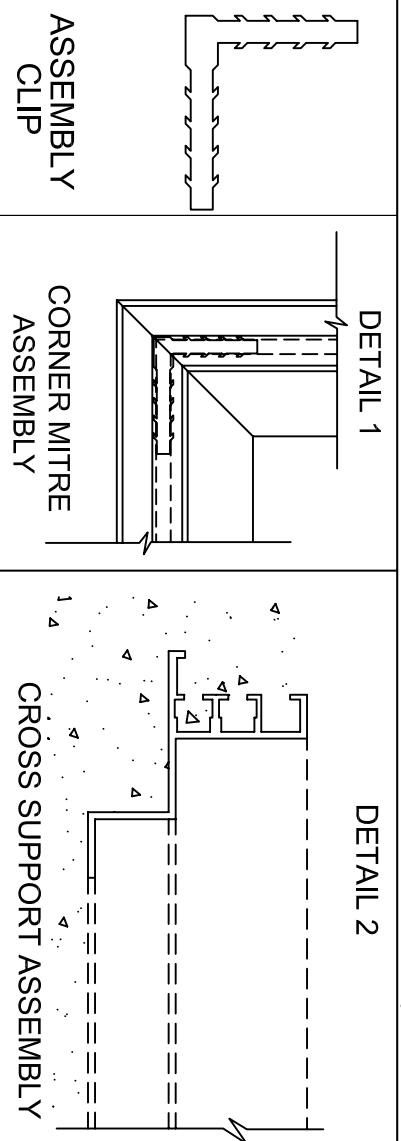
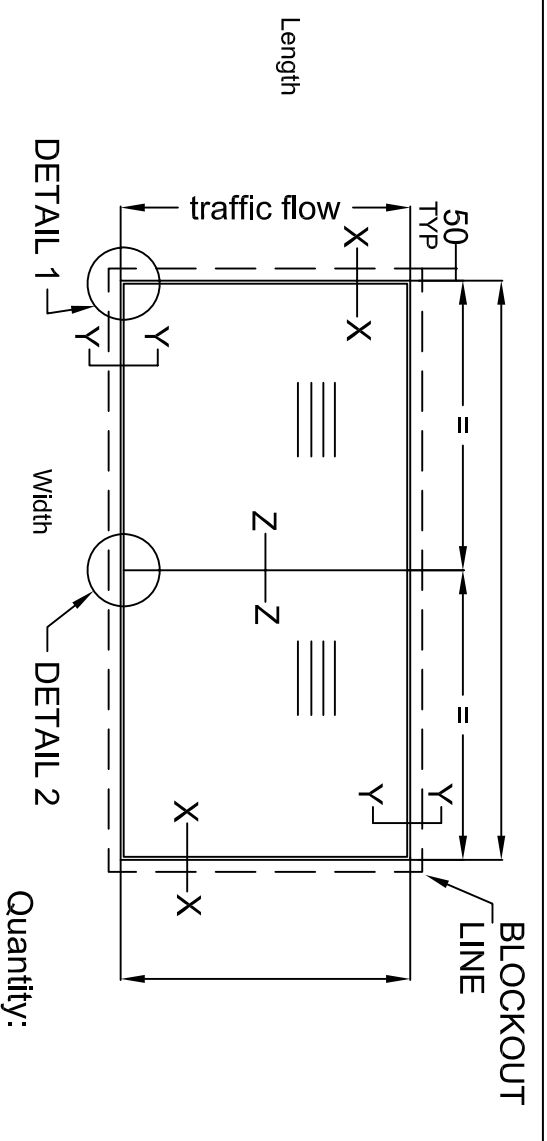

**GRILLES:**  
 Material: Aluminum 6061-T6  
 Assembly: 5/16" Steel rods  
 1/2" Aluminum spacers

**Finish Options:**  
 Mill  
 Clear anodized  
 Bronze anodized  
 Color

**FRAMES:**  
 Type: D  
 Material: Aluminum 6061-T6  
 Assembly: Field installed with corner clips

**Finish Options:**  
 Mill  
 Clear anodized  
 Bronze anodized

**Pan Options:**  
 20G. Gal. steel  
 16G. Aluminum  
 20G. Stainless steel

**Assembly:**  
 Factory installed to inside of frame pocket

**Accessories:**  
 Drain  
 Hinge  
 Lock down

File # \_\_\_\_\_ No. \_\_\_\_\_ By: \_\_\_\_\_ Date: \_\_\_\_\_ Approved: \_\_\_\_\_  
 P.O. \_\_\_\_\_

**McGill**  
 1734 Orangebrook Court  
 Pickering, Ont., L1W 3G8, Canada  
 Tel: 905-420-0485/1-888-624-4557  
 Fax: 905-420-4564/1-888-624-4558  
 Email: engineering@the-mcgill-group.com  
 www.the-mcgill-group.com